

# ACCESSORIES

MICRO COLLET	· · · · · P 91
NEW BABY COLLET	· · · · · P 92
NBC ENDMILL COLLET	· · · · · P 93
COLLET EJECTOR	· · · · · P 93
MEGA E COLLET	· · · · · P 94
STRAIGHT COLLET for MILLING CHUCK	· · P 95
PERFECT SEAL (MPS / BPS / EPS)	· · · · P 96
PULL STUD BOLT	· · · · · P 99
POINT MASTER PRO <b>PMP</b>	· · · · · P101
POINT MASTER <b>PMC</b>	· · · · · P103
POINT MASTER <b>PMG</b>	· · · · · P104
BASE MASTER SERIES	· · · · · P105
TOOL MASTER	· · · · · P107
TOOLING MATE	· · · · · P108
HOLDER LOCK	· · · · · P108
KOMBI GRIP	· · · · · P109
ST LOCK	· · · · · P109
T-SLOT CLEAN	· · · · · P109
$\alpha$ WIPER CLEANER	· · · · · P110
TK CLEANER	· · · · · P110
$\alpha$ TAPER CLEANER	· · · · · P110
$\alpha$ TOOLING CLEANER	· · · · · P111
SPINDLE CLEANER	· · · · · P111
CLEAN TEC	· · · · · P111



## POINT MASTER PRO SERIES

POINT MASTER PRO Series is a precision 3-D touch sensor which will operate in non-conductive as well as conductive applications, Resin, ceramic or coated workpieces, machines with ceramic spindle taper or bearings can all be accommodated etc.



Touch Probe & Edge Finder

### CYLINDRICAL Shank Type



For all materials, including non-conductive cutting tools, workpieces, and machine tools.

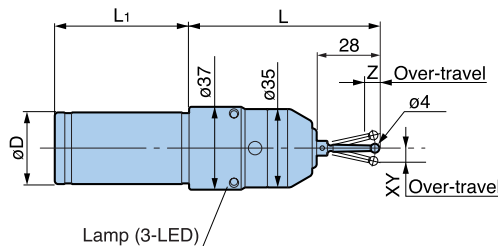

Model	øD (h7)	L	L1	Repeatability (Probe)	Over-travel		Measuring Pressure (N)		Battery	Battery life (Continuous use)	Standard Stylus	Weight (kg)
					XY	Z	XY	Z				
<b>PMP-10</b>	10	75	49	±1μm (2σ)	±12	5	0.4	1.5	Panasonic Lithium BR435×1	20hours	ST28-4R	0.4
<b>-20</b>	20	90	50						LR1×2	50hours		0.5
<b>-32</b>	32	80	60						0.6			

1. PMP-10 have one LED only.
2. Above table indicates the specification when using stylus ST28-4R.
3. There is approx 5μm lag in X & Y directions and approx. 2μm lag in Z direction to illuminate LED lamp when stylus touches workpiece surface.

### BBT Shank Type JIS B 6339 (BIG-PLUS)

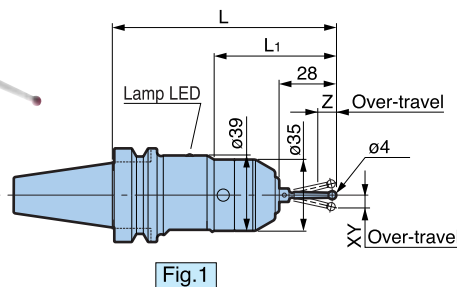
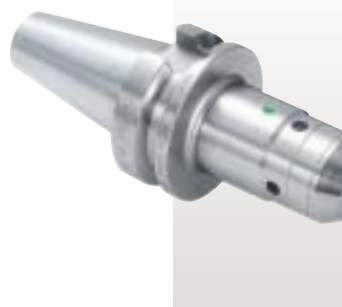

Fig.1

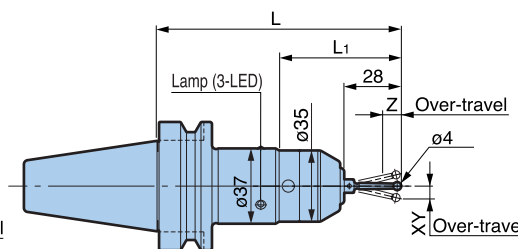

Fig.2

BIG-PLUS tools can be used in machining centers with conventional spindles.

Model	Fig.	BBT No.	L	L1	Repeatability (Probe)	Over-travel		Measuring Pressure (N)		Battery	Battery life (Continuous use)	Standard Stylus	Weight (kg)
						XY	Z	XY	Z				
<b>BBT30-PMP-110</b>	1	30	110	60	±1μm (2σ)	±12	5	0.4	1.5	SR44×2	24hours	ST28-4R	0.8
<b>BBT40-PMP-120</b>	2	40	120	60						LR1×2	50hours		1.3

1. BBT30-PMP-110 have one LED only.
2. Above table indicates the specification when using stylus ST28-4R.
3. There is approx 5μm lag in X & Y directions and approx. 2μm lag in Z direction to illuminate LED lamp when stylus touches workpiece surface.

## HSK Shank Type ISO12164&DIN69893-1

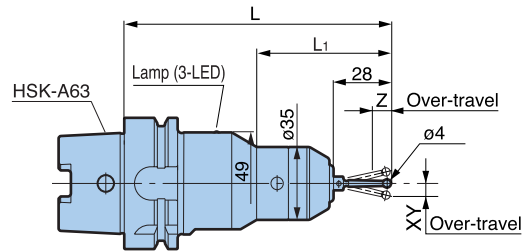

Model	HSK No.	L	L1	Repeatability (Probe)	Over-travel		Measuring Pressure (N)		Battery	Battery life (Continuous use)	Standard Stylus	Weight (kg)
					XY	Z	XY	Z				
<b>HSK-A63-PMP-130</b>	63	130	65	$\pm 1\mu\text{m}(2\sigma)$	$\pm 12$	5	0.4	1.5	CR2×1	24hours	ST28-4R	1.3

- Above table indicates the specification when using stylus ST28-4R.
- There is approx  $5\mu\text{m}$  lag in X & Y directions and approx.  $2\mu\text{m}$  lag in Z direction to illuminate LED lamp when stylus touches workpiece surface.

## ALTERNATIVE STYLII

The stylus (M3 thread) is replaceable. Please replace when different model of stylus required or if damaged.

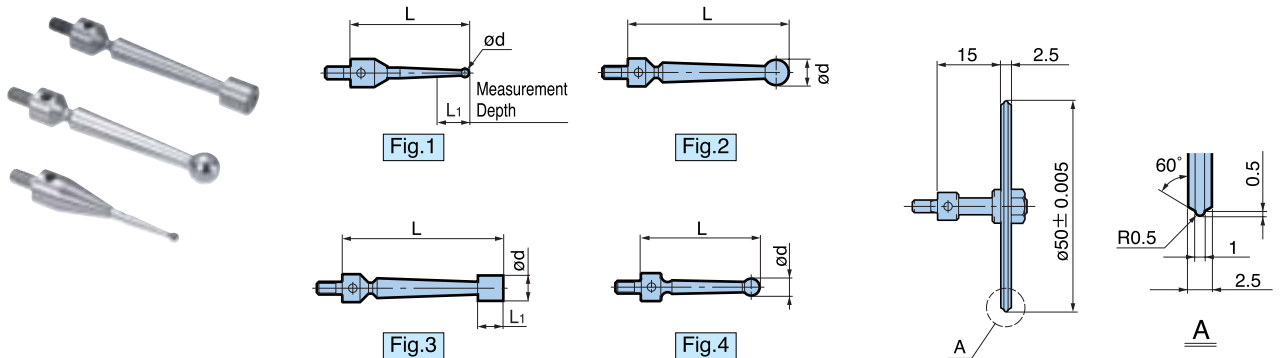

Model	Fig.	L	L1	ød	Material	Series	
<b>ST28-1P</b>	1	28	2	1	Carbide	PMG-PMC-PMP	
<b>-2P</b>			8	2			
<b>-3P</b>			4	—			3
<b>-4P</b>				4			
<b>ST38-6P</b>	2	38	—	6	Steel (SUS)	PMG-PMC	
<b>ST38-6×6</b>	3		6	6	PMG□□S-PMC□□S		
<b>ST28-4R</b>	4	28	—	4	Ruby	PMP	

※ Stylus model ST38-6×6 is exclusive for PMG□□S and PMC□□S series.  
Runout accuracy may worsen when used on PMG or series without "S".

Ideal for awkward shaped workpiece or tapered portion of plastic mold.

Model	<b>ST15-50K</b>
-------	-----------------

\* PMG&PMC-Series only.

## POINT MASTER **PMC** SERIES

POINT MASTER Series is a precision 3-D touch sensor to center and measure the workpiece.

LED lamp illuminates when the stylus touches the workpiece.  
Stroke of stylus provides sufficient over-travel for safety.



Touch Probe &  
Edge Finder

### CYLINDRICAL Shank Type

For use with conductive cutting tools, workpieces, and machine tools.

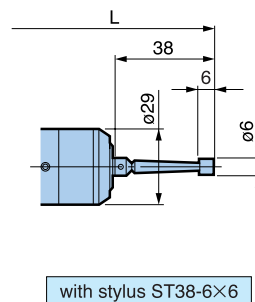
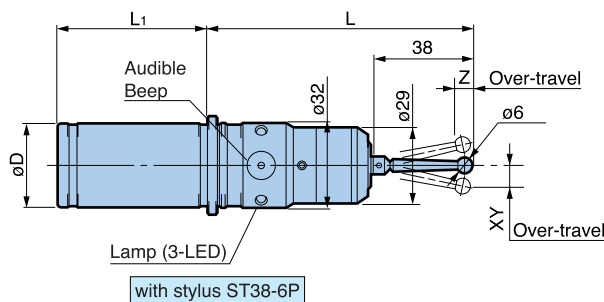

Model	øD h7	L	L1	Repeatability (Probe)	Over-travel		Measuring Pressure (N)		Battery	Battery life (Continuous use)	Standard Stylus	Weight (kg)
					XY	Z	XY	Z				
<b>PMC-20</b>	20	110	50	±1μm (2σ)	±12	5	0.6	3	LR1×2	33hours	ST38-6P	0.4
<b>-32</b>	32	102	58									0.6
<b>PMC-20S</b>	20	110	50	±1μm (2σ)	±12	5	0.6	3	LR1×2	33hours	ST38-6×6	0.4
<b>-32S</b>	32	102	58									0.6

1. ST38-6x6 cylindrical stylus is mounted on models with "S".
2. Above table indicates the specification when using standard stylus.

For stylus options:P102

### BT Shank Type

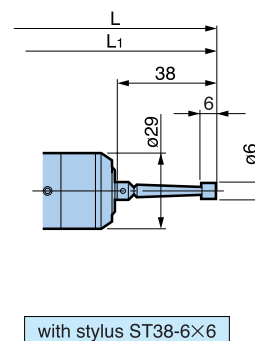
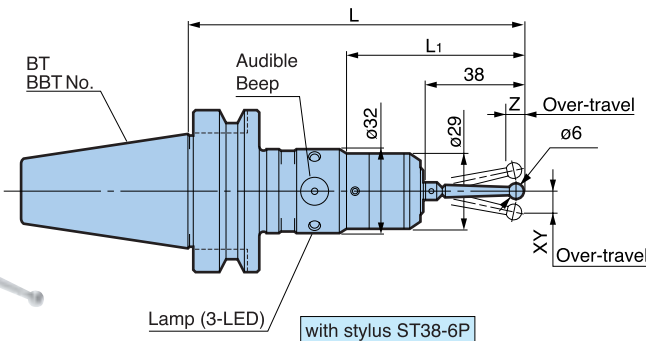

Model	BT No.	L	L1	Repeatability (Probe)	Over-travel		Measuring Pressure (N)		Battery	Battery life (Continuous use)	Standard Stylus	Weight (kg)
					XY	Z	XY	Z				
<b>BT40-PMC-130</b>	40	130	69	±1μm (2σ)	±12	5	0.6	3	LR1×2	33hours	ST38-6P	1.2
<b>BT50-PMC-160</b>	50	160										4.0
<b>BT40-PMC-130S</b>	40	130	69	±1μm (2σ)	±12	5	0.6	3	LR1×2	33hours	ST38-6×6	1.2
<b>BT50-PMC-160S</b>	50	160										4.0

1. ST38-6x6 cylindrical stylus is mounted on models with "S".
2. Above table indicates the specification when using standard stylus.

For stylus options:P102



### BBT40/50 JIS B 6339 (BIG-PLUS)

**BIG-PLUS tools can be used in machining centers with conventional spindles.**

Model	BBT No.	L	L1	Repeatability (Probe)	Over-travel		Measuring Pressure (N)		Battery	Battery life (Continuous use)	Standard Stylus	Weight (kg)
					XY	Z	XY	Z				
<b>BBT40-PMC-130</b>	40	130	69	±1μm (2σ)	±12	5	0.6	3	LR1×2	33hours	ST38-6P	1.2
<b>BBT50-PMC-160</b>	50	160										4.0
<b>BBT40-PMC-130S</b>	40	130	69	±1μm (2σ)	±12	5	0.6	3	LR1×2	33hours	ST38-6×6	1.2
<b>BBT50-PMC-160S</b>	50	160										4.0

1. ST38-6x6 cylindrical stylus is mounted on models with "S".
2. Above table indicates the specification when using standard stylus.

For stylus options:P102

## POINT MASTER **PMG** SERIES

LED lamp illuminates when the stylus touches the workpiece.



Touch Probe &  
Edge Finder

For use with conductive cutting tools, workpieces, and machine tools.

### CYLINDRICAL Shank Type

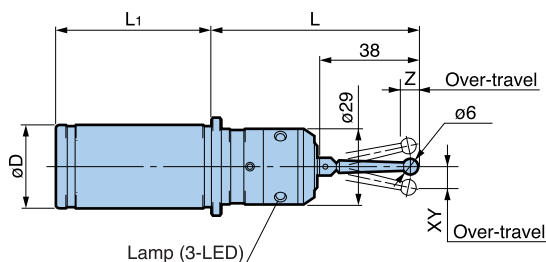

with stylus ST38-6P

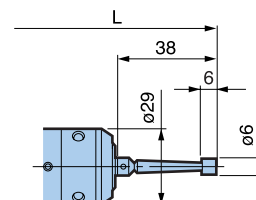

with stylus ST38-6x6

Model	øD h7	L	L1	Repeatability (Probe)	Over-travel		Measuring Pressure (N)		Battery	Battery life (Continuous use)	Standard Stylus	Weight (kg)
					XY	Z	XY	Z				
<b>PMG-10</b>	10	75	50	±1μm (2σ)	±12	5	0.6	3	Panasonic Lithium BR435×1	12hours	ST38-6P	0.2
<b>-20</b>	20	90							LR1×2	25hours		0.3
<b>-32</b>	32	80							60	0.5		
<b>PMG-10S</b>	10	75	50	±1μm (2σ)	±12	5	0.6	3	Panasonic Lithium BR435×1	12hours	ST38-6x6	0.2
<b>-20S</b>	20	90							LR1×2	25hours		0.3
<b>-32S</b>	32	80							60	0.5		

1. PMG-10 and PMG-10S have one LED only.
2. ST38-6x6 cylindrical stylus is mounted on models with "S".
3. Above table indicates the specification when using standard stylus.

For stylus options:P102

### MORSE TAPER Shank Type

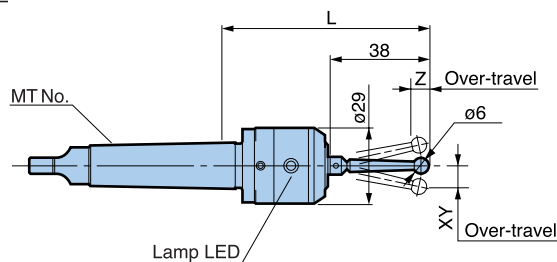

with stylus ST38-6P

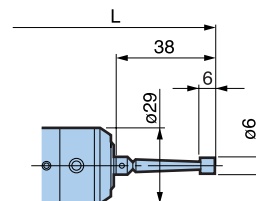

with stylus ST38-6x6

Model	MT No.	L	Repeatability (Probe)	Over-travel		Measuring Pressure (N)		Battery	Battery life (Continuous use)	Standard Stylus	Weight (kg)
				XY	Z	XY	Z				
<b>PMG-MT2</b>	MT2	80	±1μm (2σ)	±12	5	0.6	3	Panasonic Lithium BR435×1	12hours	ST38-6P	0.2
<b>-MT2S</b>										ST38-6x6	0.2

1. PMG-MT2 and PMG-MT2S have one LED only.
2. ST38-6x6 cylindrical stylus is mounted on models with "S".
3. Above table indicates the specification when using standard stylus.

For stylus options:P102

## BASE MASTER SERIES

BASE MASTER Series is a precision touch sensor to determine workpiece offsets and tool length.

Mounted on workpiece surface or machine table, LED lamp illuminates immediately when the cutting edge touches the sensor plate and the position is detected.



Tool Offset Sensor

### BASE MASTER

The most popular Base Master model with  $\pm 1\mu\text{m}$  accuracy. Operates when a conductive circuit is completed.



For use with conductive cutting tools, workpieces, and machine tools.



Model **BM-50**

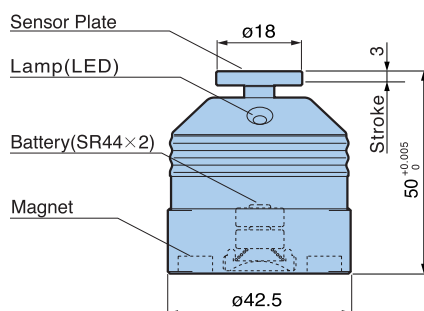

Height accuracy	$50^{+0.005}_0$ mm
Measurable pressure	3N
Repeatability accuracy	$\pm 1\mu\text{m}(2\sigma)$
Min. measurable tool diameter	$\phi 1\text{mm}$
Battery life	10hours (continuous use)
Weight	0.23kg

### BASE MASTER GOLD

Suitable for various tools and workpieces, including non-conductive materials such as ceramics.



For all materials, including non-conductive cutting tools, workpieces, and machine tools.



Model **BM-50G**

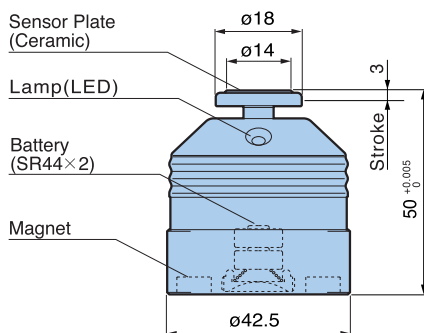

Height accuracy	$50^{+0.005}_0$ mm
Measurable pressure	3N
Repeatability accuracy	$\pm 1\mu\text{m}(2\sigma)$
Min. measurable tool diameter	$\phi 1\text{mm}$
Battery life	10hours (continuous use)
Weight	0.24kg

## BASE MASTER GOLD

Suitable for various tools and workpieces, including non-conductive materials such as ceramics.



100mm detecting height. Larger measuring head eases operation.

For all materials, including non-conductive cutting tools, workpieces, and machine tools.



**NEW**

Model **BM-100G**

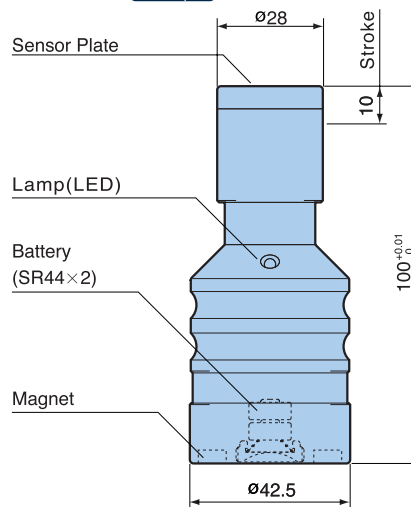

Height accuracy	100 <sup>+0.01</sup> <sub>0</sub> mm
Measureable pressure	2N
Repeatability accuracy	±1μm(2σ)
Min. measurable tool diameter	φ1mm
Battery life	10hours (continuous use)
Weight	0.36kg

## BASE MASTER MICRO PAT.P

Specifically designed for micro cutting tools. Low measuring pressure protects the cutting edge.



Pre-set **φ0.05mm** tools. Considerable reduction of set-up time for small dia. tools.

For all materials, including non-conductive cutting tools, workpieces, and machine tools.



Model **BM-50M**

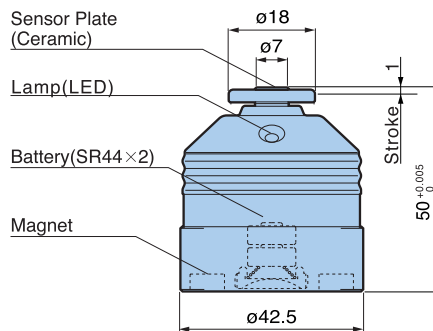

Height accuracy	50 <sup>+0.005</sup> <sub>0</sub> mm
Measureable pressure	0.3N
Repeatability accuracy	±1μm(2σ)
Min. measurable tool diameter	φ0.05mm
Battery life	10hours (continuous use)
Weight	0.24kg

## BASE MASTER SERIES

BASE MASTER Series is a precision touch sensor to determine workpiece offsets and tool length.

Mounted on workpiece surface or machine table, LED lamp illuminates immediately when the cutting edge touches the sensor plate and the position is detected.



Tool Offset Sensor

### BASE MASTER mini

- **World smallest 20mm body diameter.**
- Best suited to measurement in complicated shapes and limited space.
- High intensity Blue LED indication when the offset position is detected.



For all materials, including non-conductive cutting tools, workpieces, and machine tools.



Protection cover with magnifier(X 5)

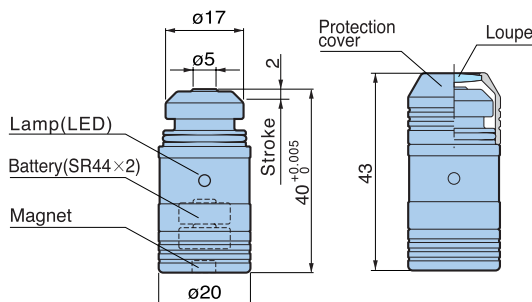

Height accuracy	40 <sup>+0.005</sup> <sub>0</sub> mm
Measureable pressure	1.8N
Repeatability accuracy	±1μm(2σ)
Min. measurable tool diameter	ø0.1mm
Battery life	10hours (continuous use)
Weight	55g

Model **BMM-20**

## TOOL MASTER

TOOL MASTER is a precision touch sensor with a large dial gauge. LED lamp and sound pre-indicate approach to 100mm height to ease the detecting operation.



Tool Offset Sensor



Model **TM-100**

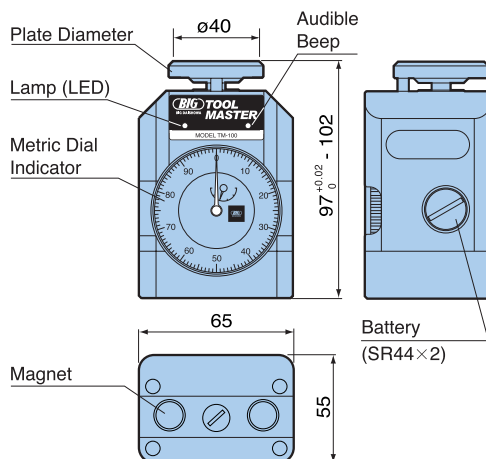

For all materials, including non-conductive cutting tools, workpieces, and machine tools.

Height accuracy	100 <sup>+0.02</sup> <sub>0</sub> mm	
Stroke	5mm	
Stroke range	97 - 102mm	
Measureable pressure	6N(100mm)	
Weight	1.2kg	
Dial gauge	Graduation	0.01mm
	Indication tolerance	±15μm
	Repeatability	5μm
	Return tolerance	5μm

\* Dial gauge accuracy in accordance with JISB7503:1997.